

PracSavvy

Clinical Systems Support and Training

www.pracsavvy.com.au

Edition 113 - January 2026

Welcome to the first newsletter of 2026. Hoping everyone had a nice Christmas and had/is having a relaxing break. As is mostly the tradition this edition is um, small but perfectly formed. Having said that, if you are a BP user, you should definitely get to page 2 for some important time relevant information.

MyHR

This bugs me more than it should and I can't really articulate why but the MyHealth app is being [rebranded to 1800Medicare](#). To recap, the MyHealth app is how you access your MyHR via your smartphone. What's more it's a really well designed app in terms of screen layout etc. It's apparently been downloaded 4.2 million times as at March 2025. It makes sense too, MyHealth app to access MyHealth Record.

Now I know the government have a new Medicare help line to promote and I know our prime minister goes to bed in medicare themed jim-jams, but why name an app after a phone number. That has a real 90's feel to it for me, notwithstanding the fact that it masks the main usage of the application. You have always been able to access Medicare billing history and MyMedicare registration via this app, and I sense there is more Medicare functionality on the way. But this stuff is the bread roll to what is the main meal. (I'm writing this at tea time)

I do also know that there was a Medicare specific app that was discontinued a few months ago, and I understand a need to consolidate. Fine, but not at the expense of the core purpose of the program. Actually that's a thing that plenty of places get wrong, namely letting *other stuff* get in the way of delivery of their core purpose. It also occurs to me that whilst overseas students for instance are Medicare illegible, they can apply for a HI number and subsequently have a MyHR. They of course would access the record via a program named after a system they aren't eligible for. I should also point out (as I conclude my rant) that you can access these Medicare services through the MyGov app as well.

On a semi-related note the government recently released it's [National Allied Health Digital Uplift Plan](#) (which is nowhere as rude as it sounds). It's probably high time for some reaching out to the Allied Health sector in terms of technology modernisation. I am aware though of the potential for angst around Allied Health having access to MyHR. I feel like there are plenty of people who are happy with GP and tertiary health access, but may not feel the same way about their physiotherapist. This potential broadening of access may require some careful management.

On the subject of improved use of technology in the sector, I'm aware of a few hundred funded Healthlink mailboxes allocated to allied health types and pharmacies around the state. I'd be really interested to know how many of these are being used regularly. I am actually pleased to note that after not checking for a long time, many of these Healthlink addresses are now shown in the [Tasmanian Health Directory](#). It wouldn't be the worst idea for practices to check these listings in case any of their usual customers have a secure correspondence pathway that they are unaware of.

Lifted from a recent GPLO newsletter is the reminder that if you want your THS referrals to be graded as Urgent and trigger all the bells and lights, you have to check the provided option. Writing this in the provided free text boxes will not get it done. Click the option!

Estimated Appointment Waiting Times

Urgent ⓘ
Urgency Reason*
Have you discussed with DoH/THS clinician* Yes No

[Arthritis Australia](#) have just launched a new comprehensive [Gout toolkit](#), aimed principally, but not just at Indigenous people. Whilst I'm usually highly sceptical about endorsement for health campaigns by celebrities or professional athletes, I'd be lying if I said I didn't see some potential [here](#).

PracSavvy

Clinical Systems Support and Training

www.pracsavvy.com.au

BP

BP users should be on the ball and ensure that their IT have processed the TLS security update that I mentioned in the December issue. This really has to be done prior to February 3rd, else all sorts of stuff related to HI numbers and Proda will cease to work. Updated information to be [gleaned here](#).

Speaking of deadline dates, BP have announced that as from TODAY 3rd party programs will only be able to access BP via the HALO connect platform. For 3rd party programs, think online bookings, audit tools (e.g. Primary Sense) and any online care planning tools. For a lot of practices this has been happily going on for a while and it may be that you may not notice any change. However, if something stops working, you may be required to enable the “via Halo Connect” method in your configuration.

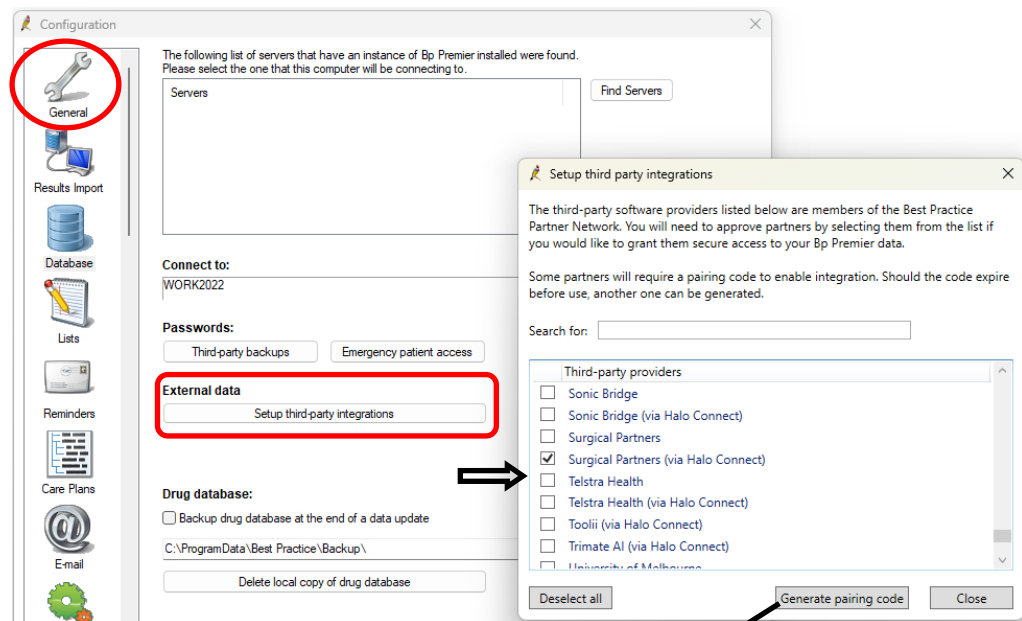

Some of these 3rd party products may also require you to provide them with a unique “pairing code” at some point.

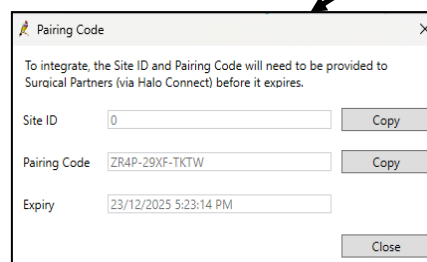

I wouldn't adjust any configuration here until the 3rd party vendor tells you you have to, (or something stops working) When that time comes, good information around this topic can be found [here](#).

Is your BP database running slower than it should be? Occasionally when training I will foolishly click the *Next Appointment* button at the top of the appointment book. Ideally this will give you a list of the next free slots for all your practitioners, whereby you can book an appointment. What actually does happen is that I see the dreaded spinning blue circle for several minutes, leaving me to make awkward small talk whilst praying that I haven't crashed the program.

This is a symptom of a fragmented database. Some may be old enough to remember to a time when your pc ran super slowly and after all other avenues had been exhausted (turning it on and off) a Defrag was the order of the day and you could while away the hours watching the coloured blocks tidy themselves up. Well there is a defrag type activity for your BP database and it's more properly referred to as an SQL Index rebuild. It's a highly worthwhile maintenance activity that can be scheduled for any time that you want. For example, once a week outside of work hours. The bigger the database the more benefit to be gained. If your IT aren't aware of it, the relevant information can be [read here](#).

| Medical Director | | Best Practice | | Various Other | |
|--------------------------------|--------|------------------------------------|--------|---------------------------------|--------|
| Active Ingredient Prescribing | Jan/21 | 3DA Clinic | Mar/20 | Active Script List | Jan/22 |
| Actions | Apr/21 | Actions | Dec/20 | AI-Scribing | Sep/24 |
| Admin- Shared Task List | Oct/24 | Admin Monitoring Tasks | Jul/18 | AI-Scribing - Bits | Oct/24 |
| Alias Creation | Aug/21 | Admin- Shared Task List | Oct/24 | Care Planning changes | Jul/25 |
| Bulk Pop-Up Alerts | Sep/17 | Appointment Book Columns | Aug/20 | ChatGPT | Mar/23 |
| Cancer Screening Widget | Sep/21 | Active Ingredient Prescribing | Jan/21 | Cloud explained | Jul/22 |
| Clinical Data Statistics | Jul/18 | Addons 3rd Party | Jul/22 | Communication Tips | May/21 |
| Clinical Prompts Widget | May/21 | Atomised Results | Aug/25 | Communication Ambig terms | Jun/21 |
| Coded\Uncoded entries | Aug/19 | Autofill, - Record Note | Apr/18 | Covid Vacc - Inactivating | May/22 |
| Confidentiality | Jul/19 | Better Consult Extension | Apr/20 | CTG Registration | May/22 |
| Cubiko | Dec/22 | Better Health App | Nov/19 | Doctors Control Panel | Sep/18 |
| Document Actions | Aug/18 | Better Health Update | Oct/23 | Dora PKI Sha1 Issue | Dec/23 |
| Duplicate Patients | Dec/21 | Blank Name Fields | Feb/22 | Electronic signatures | Oct/22 |
| e-scripts | Dec/20 | Bowel Screening Prompt | Nov/23 | e-ordering | Jun/25 |
| Electronic Correspondence Tips | Jun/18 | BP Hot Tips - Part 1 | Nov/24 | Ereferral - THS Pilot | Jun/20 |
| E Correspondence "Ref" fix | Jul/20 | BP Hot Tips - Part 2 | Dec/24 | Ereferral THS More | Jul/21 |
| Email | Nov/22 | Broken things | Jul/23 | Ereferral THS NW | Mar/23 |
| ereferral -attaching Documents | May/19 | Care Plan Templates | Nov/17 | Ereferral THS South plus issues | Jun-23 |
| e-referral Smartforms | Dec/19 | Cervical Screening Changes | Dec/17 | ereferral - Updating and Info | May-24 |
| e-referral Smartforms A/H | Jan/23 | Coded\Uncoded entries | Aug/19 | ereferral -Updating more | Feb-25 |
| Favourite Lists | Apr/19 | Confidentiality | Jul/19 | ereferral Issues | Aug-23 |
| Filters | Mar/23 | Confidentiality - Documents | Oct/20 | ereferral MyHealthlink Portal | Sep-23 |
| Free Flu Vacc search | May/20 | Confidentiality - User Permissions | May/21 | ereferral - Specialist Profile | Apr/23 |
| Front Screen Utilities | Sep/19 | Contact Notes view all | Nov/19 | erequests Hobart Pathology | May/24 |
| Healthlink Smartforms | Dec/22 | Data Tree | Sep/17 | escripts checklist | Jul/20 |
| Hobart Path tip | Apr/21 | Dementia Assessment | May/18 | escripts - 2 tips | Apr/23 |
| Immunisations declined | Jun/21 | Duplicate Patients | Dec/21 | GoShare Plus | Apr/20 |
| Inactivating Holidaymakers | Mar/20 | Efax Tip | Sep/22 | Gross Initiative | May/25 |
| InBox Layout | Dec/21 | Email | Jun/20 | Healthlink Methods | Jun/21 |
| Incoming Message Locations | Feb/19 | Email PIN Hint | Apr/24 | Healthlink Directory Options | Mar/24 |
| Letter Writer field properties | Oct/21 | EPC Templates | Feb/24 | Healthlink Provider Map | Apr/24 |
| Letter Writer - Data Toolbar | Feb/18 | E-Scripts | Sep/20 | Healthlink Costs GP | Jan/25 |
| MD 4.2 Release | Mar/22 | e-referral Smartforms | Dec/19 | Healthy Habits app | Oct/23 |
| Md 4.2 more | May/22 | e-referral Smartforms A/H | Jan/23 | Hep C Scripts | Dec/21 |
| MD 4.3 | Mar/24 | e-referral template | Oct/22 | Hobart Path Interface BP | Mar/21 |
| MD 4.3a | May/25 | Free Flu Vacc Search | May/20 | HPI-I Issues | Aug/25 |
| MD Maintenance | Nov/19 | Gender Fields | Oct/20 | Lyrebird | Jul/24 |
| MedicalDirector Cover | Aug/22 | GPMP Reviews from EPC Doc | Feb/22 | Medicare Web Services | Jul/21 |
| MedicalDirector Care | Mar/21 | Halo Connect | Jan/26 | Meditracker App | Jun/17 |
| Medication List Errors | Jun/19 | Health Assessments | Nov/22 | My Aged Care Referral | Nov/19 |
| Missing Document Date | Nov/17 | HealthlinkSmartforms | Dec/22 | MYGPPortal MYGPMPTool | Jan/23 |
| Monitoring eReferrals | Aug/20 | Healthlink hack | May/24 | MyHR Apps | Apr/21 |
| MyMedicare Data Import | Jun/24 | HLConnect Messages - Viewing | Jul/20 | MyHR - Covid/Bowel Screening | Aug/20 |
| Pathology follow Up | Oct/18 | Imaging Paper Setup | Jul/20 | MyHR- Covid bump | Aug/22 |
| PKI Housekeeping | Dec/18 | I-Med ereferral | Oct/20 | MYHR - Immunisations report | Jun/21 |
| Recall Tips | Mar/18 | Immunisations - elsewhere | Jun/21 | MyHR - Medicines View | Nov/17 |
| Results - Missing documents | Jul/17 | Inactivating Holidaymakers | Mar/20 | MyHR - Disaster Application | Sep/19 |
| Saving Filters | Aug/18 | Incoming Message Locations | Nov/22 | MYHR - Emergency Access | Oct/21 |
| Searching Documents | Nov/16 | Internal Messaging and Reminders | May/17 | MyHR - examples | Jun/18 |
| Searching Pathology | Oct/17 | Message To TO DO List | Sep/21 | MyHR - Hobart Path upload | Mar/21 |
| Searching Progress Notes | Nov/16 | Medication List errors | Jun/19 | MyHR - Legislation Changes | Dec/18 |

| Medical Director | | Best Practice | | Various Other | |
|---------------------------|--------|------------------------------------|--------|---------------------------------|--------|
| Shared Record Access | Mar/17 | MyMedicare Importing Registrations | Mar/24 | MyHR- Medical Conditions View | Aug/24 |
| Sidebar Widgets | May/18 | Orchid Release | Feb/23 | MyHR - MyHealth App | Apr/23 |
| SmartScribe AI | Mar/25 | Orchid SP1 Release | Sep/23 | MyHR-New Reports | Oct/19 |
| SHS Uploads - Counting | Jan/20 | Orchid Sp1 Rev1 | Feb/24 | MyHR - Uploading Labs | Aug/21 |
| SMS Capabilities Reminder | May/17 | Orchid Sp2 | Jul/24 | MyHr App | Mar/17 |
| SMS Recalls & Results | Oct/16 | Pathology Favourites | Aug/21 | MyHr ePIP shortfall | May/17 |
| Speed tips | Oct/24 | Pathology Follow Up | Oct/18 | MyMedicare Tips | Aug/25 |
| Telehealth Widget | May/20 | Pathology Hob/Lton/NW tip | Mar/21 | Nash Expiry | Feb/22 |
| Template Tips | Nov/17 | PKI Housekeeping | Dec/18 | NASH SHA1 SHA2 Check | Sep/22 |
| Template Checking | Sep/19 | Prescribing Tips | Feb/20 | Notifiable Data Breaches | Mar/18 |
| Travel Medicine | Apr/19 | Preferences | Jan/23 | Past Medical History - Context | Dec/22 |
| Utilities under Menus | Feb/17 | Preferences - Optimal | May/25 | PKI - A history | Apr/22 |
| Vaccination entry bug | Dec/21 | Provisional Diagnosis | Aug/20 | Primary Sense Over 75 ha | Oct/23 |
| Why It's better | Oct/20 | Quick Tips | Mar/18 | Primary Sense - Child Imms | Jun/24 |
| | | Recurring Appointments | Feb/22 | Primary Sense - GP Dashboard | Jun/25 |
| | | Reminder Cleanup Tool | Jan/20 | Primary Sense - Hep C Report | Dec/25 |
| | | Reporting Tool SQL | Jun/25 | Primary Sense -Initial thoughts | Feb/23 |
| | | Results - Missing documents | Jul/17 | Primary Sense -Intro | Jun/23 |
| | | Running all Checks - Lava | Nov/16 | Primary Sense new queries | Nov/23 |
| | | Saffron Release | Feb/21 | Privacy Act Amended 2024 | Oct/25 |
| | | Scanning Settings | Nov/20 | PS - CKD and Lungs | Jul/25 |
| | | Scanning more | Jan/22 | Primary Sense Palliative Report | Apr/24 |
| | | Searching the Database | Nov/18 | Privacy - Reasonable Care | Dec/23 |
| | | SHS Uploads - Counting | Jan/20 | Screen Capture | Oct/20 |
| | | Smartform Allergies | Jun/24 | Secure Messaging- 3 years | May-19 |
| | | Smartform - Smoking | Aug/25 | Security - Self Defence | Han-21 |
| | | SMS useful bits | Oct/21 | SMS for the elderly | Dec/21 |
| | | Spectra Release | Jan/25 | Snug Health App | Dec/19 |
| | | Spectra SP1 Release | Mar/25 | Symbol Insertion | Jul/22 |
| | | Spectra Sp1 R2 | Sep/25 | System Maintenance | Jun/17 |
| | | Spectra Sp1 R3 | Nov/25 | TasScript | May/24 |
| | | Spectra Missing data Report | Jun/25 | Teamwork | Sep/19 |
| | | SQL Indexing | | Tips from Practices | Sep/22 |
| | | Subpoena Tool | Dec/25 | TopBar - PIP QI | Dec/19 |
| | | Template Tips | Nov/17 | Transferring Patient files | Jun/22 |
| | | Template Checking | Sep/19 | Web Services Tips | Aug/22 |
| | | To Do List | Dec/25 | | |
| | | Unallocated Items plus Inbox | Apr/21 | | |
| | | Utilities under Menus | Feb/17 | | |
| | | Uncoded diabetics | Dec/20 | | |